

This product is intended for single family home/residential use only and not intended for use in any public setting. Placement in any public setting constitutes a misuse of this product.

All hardware on this set is specially coated for corrosion resistance. If non-Creative Playthings hardware is used, it must be galvanized or stainless steel.

Your play tower assembly guide provides additional information on the care and use of your play set.

Read the entire instruction manual before the assembly of the counter & shelf.

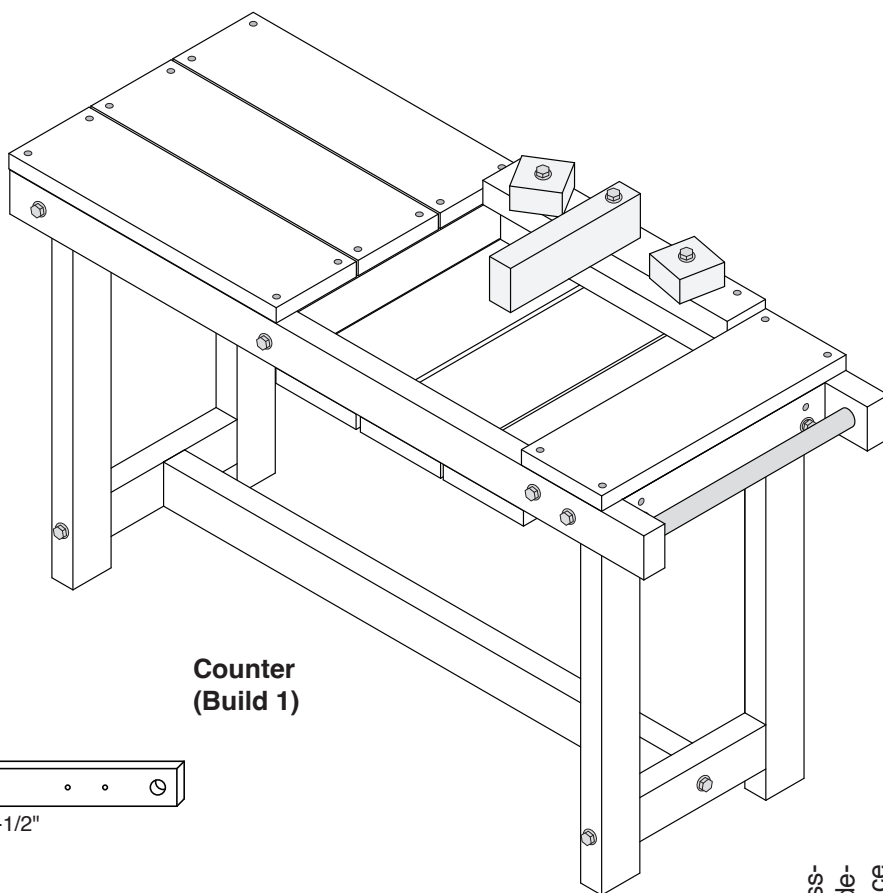
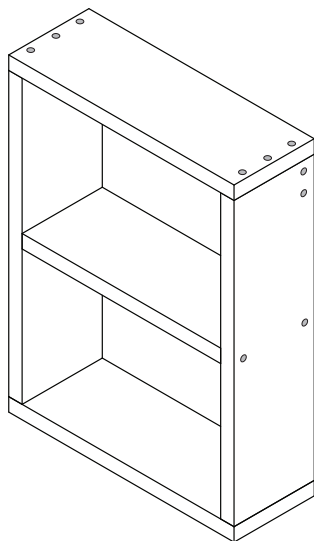

**Shelf
(Build 1)**

**Counter
(Build 1)**

COUNTER & SHELF - AZ977-102

- A 2 35727-102 Counter Support 2 x 3 x 41-1/2"
- B 4 35728-102 Leg 2 x 3 x 23-1/8"
- C 2 35729-102 Side Stretcher 2 x 3 x 8-1/4"
- D 1 35730-102 Long Stretcher 2 x 3 x 33-1/4"
- E 2 35731-102 Counter End 2 x 3 x 13-1/4"
- F 2 35732-102 Counter Stringer 2 x 3 x 13-1/4"
- G 3 35733-102 Counter Board 5/4 x 6 x 17-1/2"
- H 4 35734-102 Sink Board 5/4 x 6 x 16"
- I 1 35735-102 Sink Back 2 x 3 x 16"

- J 2 35736-102 Tap Handle 2 x 3 x 2-1/2"
- K 1 35737-102 Tap 2 x 3 x 8-1/2"
- L 2 35738-102 Shelf Side 5/4 x 6 x 18-1/2"
- M 2 35739-102 Top & Btm Shelf 5/4 x 6 x 14-3/4"
- N 1 35740-102 Mid Shelf 5/4 x 6 x 13"
- O 1 35741-102 Shelf Support 2 x 3 x 13"
- P 1 50580-700 Hardware, Counter & Shelf

Component Part Identification:

Take inventory of all parts, making sure nothing is missing or defective. If you find that parts are missing or defective call the Creative Playthings Customer Service Department at 1-800-598-4997.

HARDWARE BAG CONTENTS

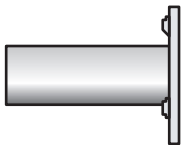

1/4" Weld Nut



1/4" Lock Washer

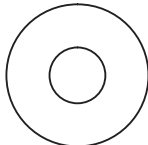

1/4" Flat Washer

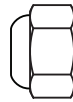

1/4" Lock Nut



#10 x 1-5/8" Screw



#10 x 2" Screw



#10 x 2-1/2" Screw



1/4 x 3" Lag Screw

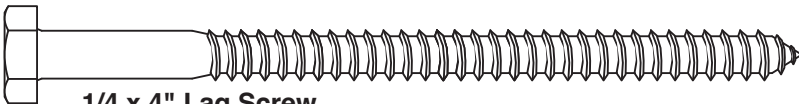

1/4 x 4" Lag Screw

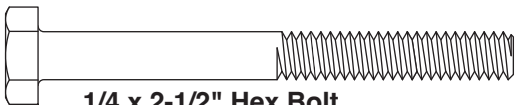

1/4 x 2-1/2" Hex Bolt

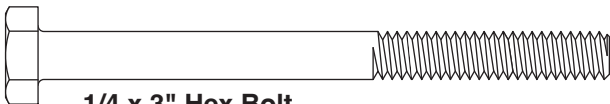

1/4 x 3" Hex Bolt

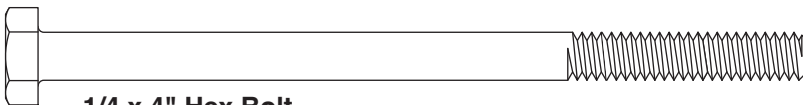

1/4 x 4" Hex Bolt

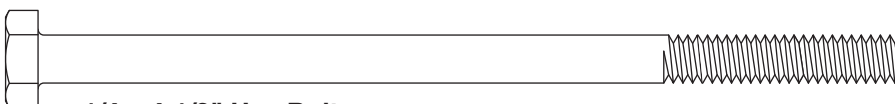

1/4 x 4-1/2" Hex Bolt

Hardware, Counter & Shelf

9	17001-104	Weld Nut 1/4"
2	17052-105	Lock Nut 1/4"
31	12002-205	Flat Washers, 1/4"
8	12017-205	Lock Washers, 1/4"
4	17003-1009	Hex Bolt 1/4 x 2-1/2"
2	17003-1409	Hex Bolt 1/4 x 3-1/2"
5	17003-1609	Hex Bolt 1/4 x 4"
16	17020-115	Screw, #10 x 1-5/8"
28	17020-107	Screw, #10 x 2"
16	17020-113	Screw, #10 x 2-1/2"
11	17036-1201	Lag Screw, 1/4 x 3"
4	17036-1601	Lag Screw, 1/4 x 4"

We have packaged more hardware than is required for assembly.

Tools & Materials Suggested for Finishing & Assembly:

- Claw Hammer
- Carpenter's Level
- Box Wrench or Sockets (7/16")
- 1/8", 3/16" Drill Bits (High Speed)
- Screwdriver or driver drill (Medium Phillips)
- Pliers
- 10 ft. Tape Measure
- Framing Square
- Beeswax or Soap (Used to lubricate screw threads)

ASSEMBLY INSTRUCTIONS

STEP 1 – Table Stretchers and Legs:

Fasten the two Counter Stretchers (C) squarely to the Long Stretcher (D) using two 1/4 x 3" Lag Screws with Flat Washers.

Follow by fastening each Leg (B) to the assembly using 1/4 x 4" Lag Screws with Flat Washers. Make sure the whole assembly is square.

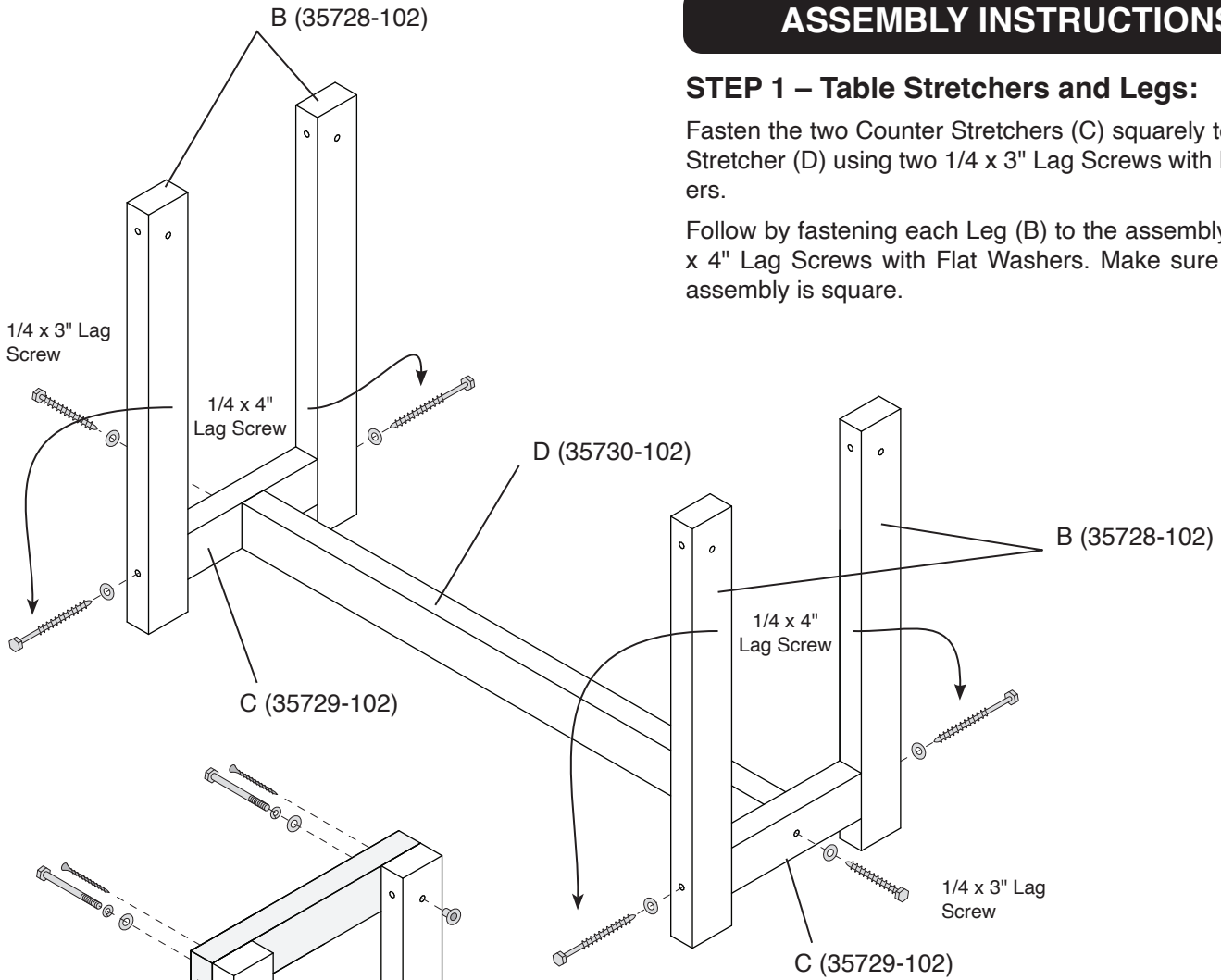

STEP 2 – Counter Ends:

Secure the tops of the Legs (B) to the Counter Ends (E) using #10 x 2-1/2" Screws and 1/4 x 2-1/2" Hex Bolt assemblies* as shown.

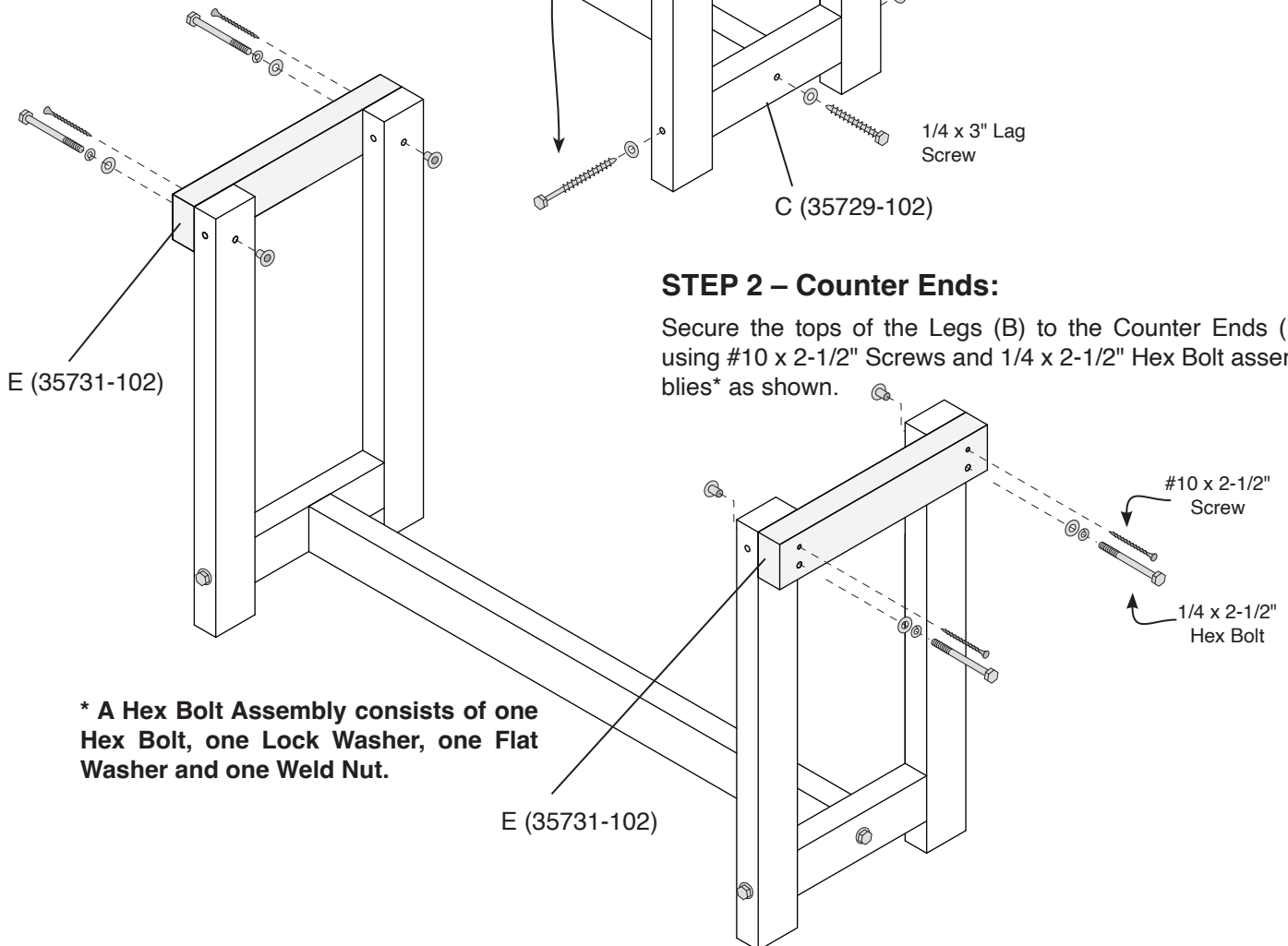

* A Hex Bolt Assembly consists of one Hex Bolt, one Lock Washer, one Flat Washer and one Weld Nut.

ASSEMBLY INSTRUCTIONS

STEP 3 – Counter Supports, Stringers & Towel Bar:

Place the Towel Bar between the two Counter Supports (A) and fasten each of them to the leg assembly using 1/4 x 4" Hex Bolt assemblies as shown. Follow by securing the Counter Stringers (F) between the Counter Supports using a 1/4 x 3" Lag Screw and a Flat Washer in each end.

Again make sure the counter frame is square.

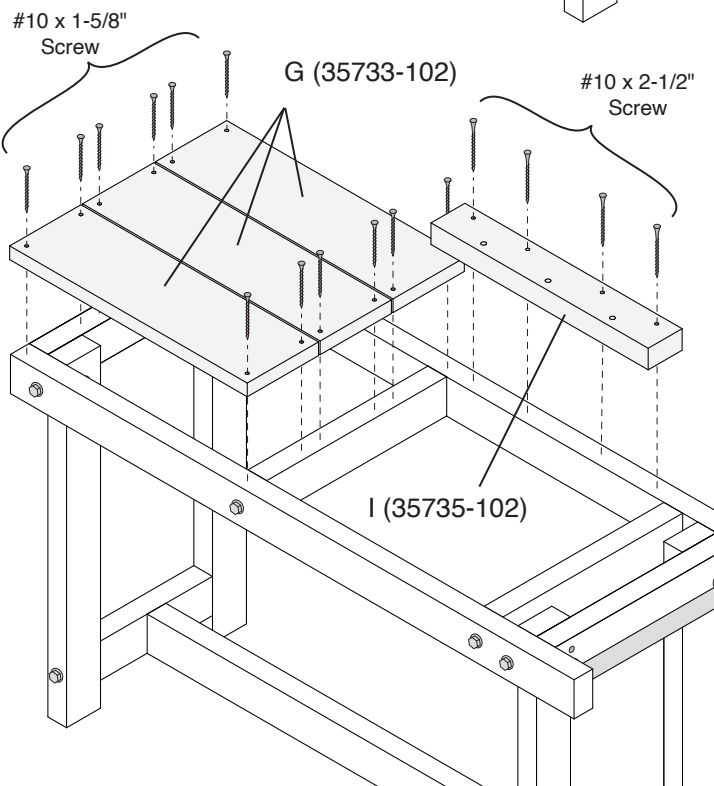
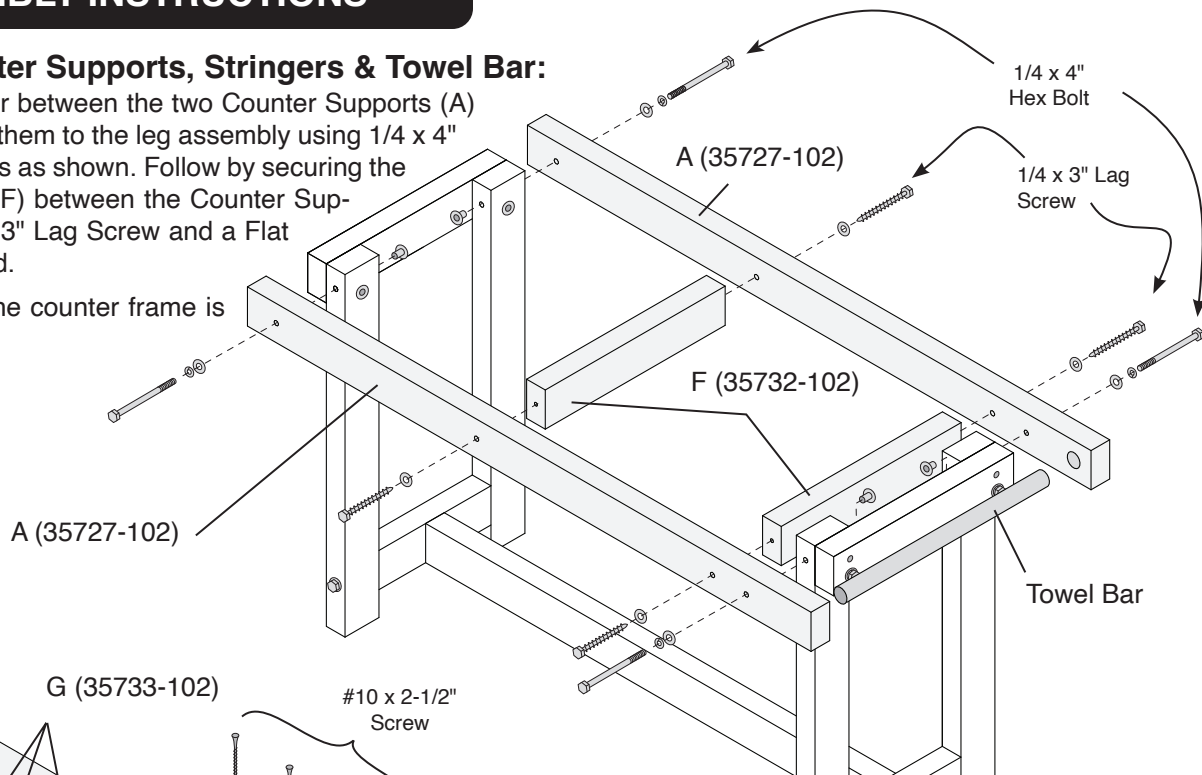

STEP 4 – Counter Boards & Sink Back:

Lay out the Counter Boards G on the frame. Secure them using four #10 x 1-5/8" Screws each. Set the Sink Back (I) on the frame butted to the Counter Boards and the back of the Counter frame. Fasten it in place using four #10 x 2-1/2" Screws.

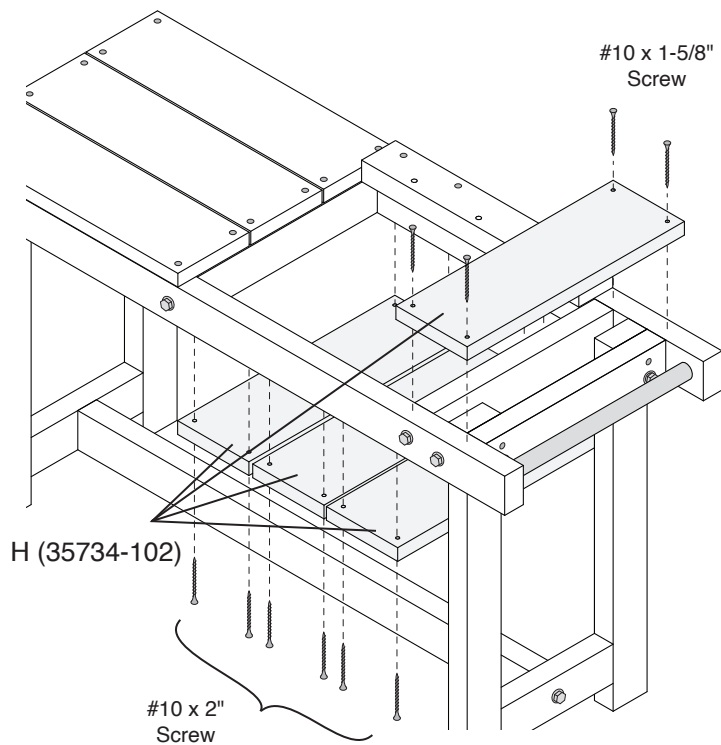

STEP 5 – Sink Boards:

Use three Sink Boards (H) as the bottom of the sink. Secure them to the Counter Supports using #10 x 2" Screws. Place the last sink board on the counter, as shown. Fasten it with four #10 x 1-5/8" Screws.

ASSEMBLY INSTRUCTIONS

STEP 6 – Handles & Tap:

Fasten each Tap Handle (J) to the Sink Back using one 1/4 x 3-1/2" Hex Bolts, three Flat Washers, and a Lock Nut, as shown. Leave them loose enough to spin, but not come loose.

Follow with a 1/4 x 4" Hex Bolt with two Flat Washers and a Weld Nut to mount the Tap (K). Leave it loose enough to pivot, but not come off.

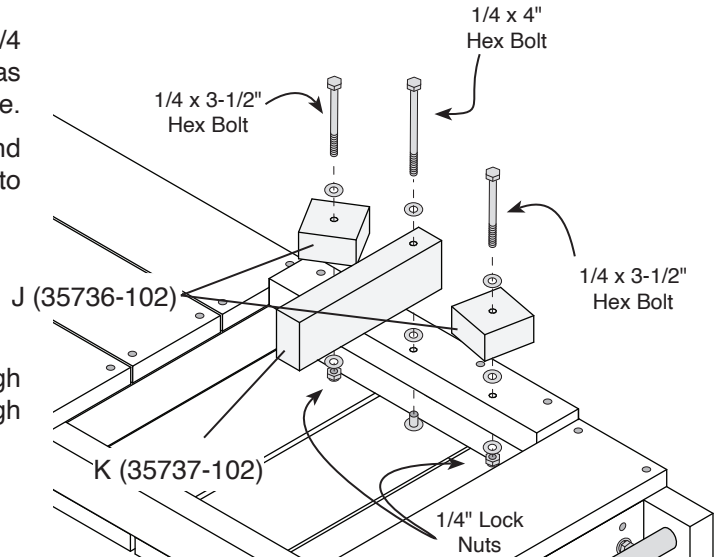

STEP 7 – Counter to Gym:

Mount the counter to the gym using 3" Lag Screws through the frame and into the wall frame and 2-1/2" Screws through the Legs and into the floor.

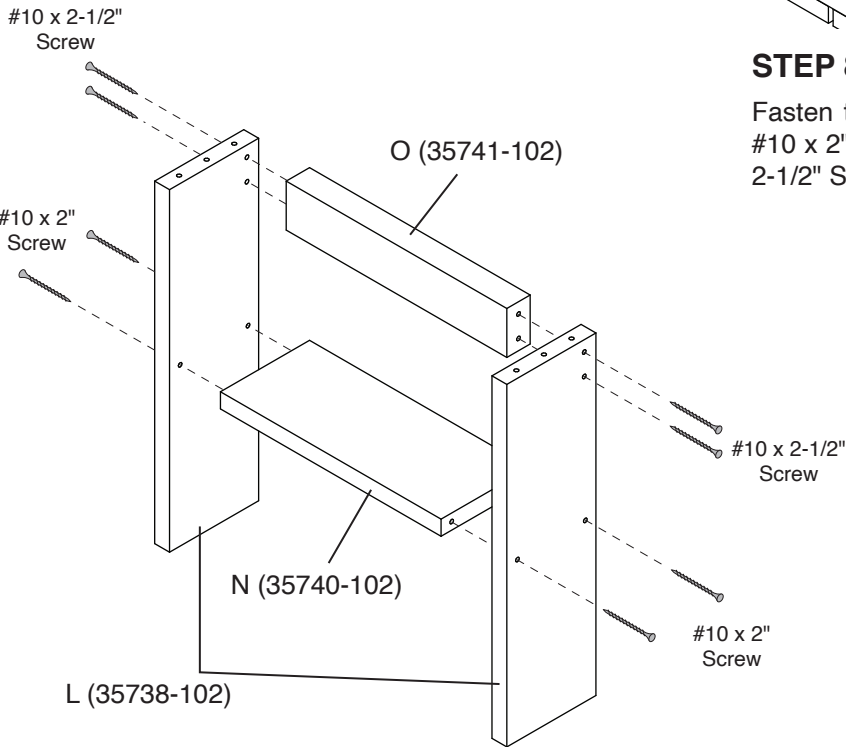

STEP 8 – Sides to Support & Middle Shelf:

Fasten the Shelf Sides (L) to the Mid Shelf (N) using four #10 x 2" Screws and the Shelf Support (O) using two #10 x 2-1/2" Screws at each end.

STEP 9 – Shelf Ends:

Make Sure the shelf is square before attaching the Top and Bottom Shelf to the Shelf Sides using six #10 X 2" Screws each.

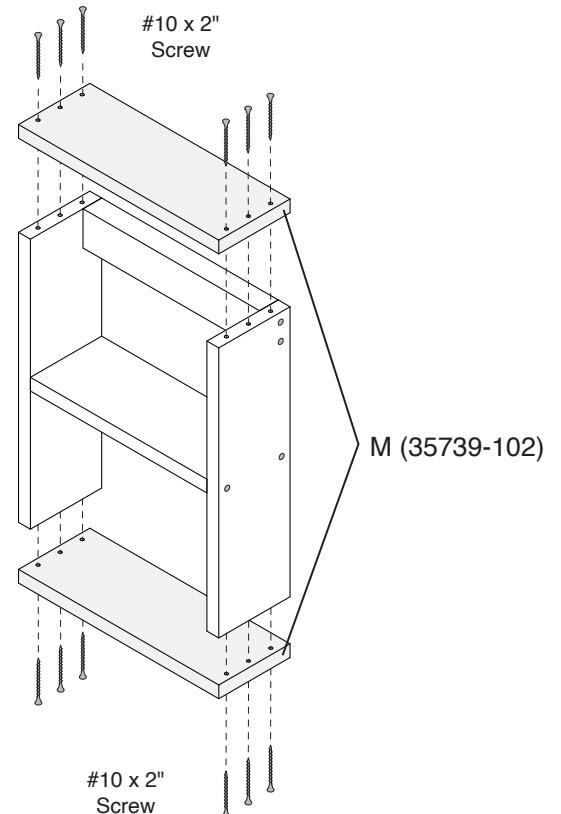

STEP 10 – Shelf To Gym:

Attach the Shelf to the gym walls in a way it does not cause an entrapment. If the gap allows a 3" x 6" rectangle it must also allow a 9" diameter circle. 3" Lag Screws and Flat Washers are provided.