

Norfolk Tire Swing Assembly

63045-505

Creative Playthings®

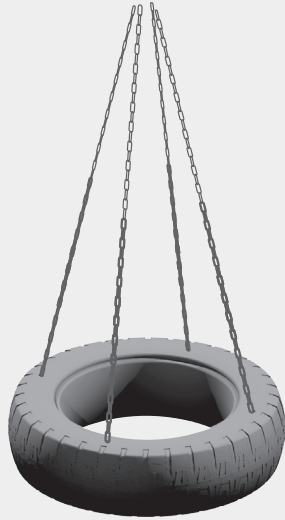

All hardware on this set is specially coated for corrosion resistance. If non-Creative Playthings hardware is used, it must be galvanized or stainless steel.

In order to avoid potential accidents, caution children to use this accessory only in its intended manner. A child should **never** wrap the rope or chain around any part of their body.

Parts:

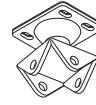

| | | | |
|---|---|-----------|----------------------------|
| A | 1 | 40482-100 | Four Chain Tire Swivel |
| B | 1 | 15148-400 | Molded Plastic Tire, Green |
| I | 1 | 50408-134 | Hardware Bag - Tire Swing |
| C | 4 | 12054-105 | Fender Washer 3/8 x 1-1/2" |
| D | 8 | 12002-207 | 3/8" Flat Washer |
| E | 4 | 12052-107 | 3/8" Lock Nut |
| F | 4 | 12038-103 | 1/4" Quick Link |
| G | 4 | 40323-105 | Chain Assembly, 34" |

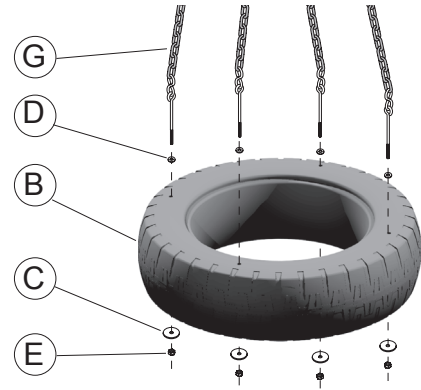

STEP ONE - Assemble Tire Swing:

Insert the Eye Bolt from each Chain Assembly through a 3/8" Flat Washer and into the holes on the top of the Tire. Attach using 3/8 x 1-1/2" Fender Washers and 3/8" Lock Nuts in the bottom recesses of the tire. Tighten all hardware. See illustration.

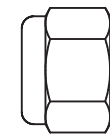
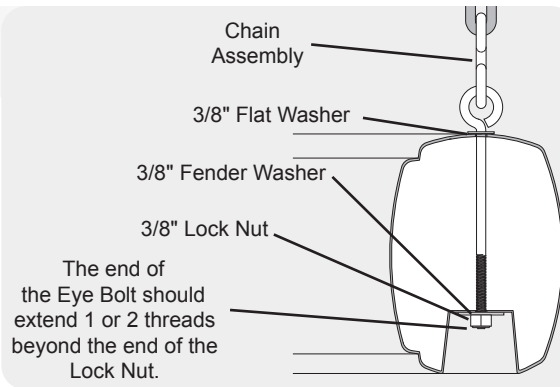

3/8" Lock Nut

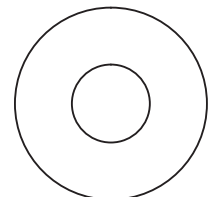

3/8" Flat Washer

STEP TWO - Hang the Tire Swing:

Open the 1/4" Quick-Links at the end of each chain. Install each of the links through the four holes in the Swing Hanger (A). Use a wrench to securely tighten the Quick-Links.

NOTE: the Tire Swing height can be adjusted by moving the Quick Link to another link on the chain.

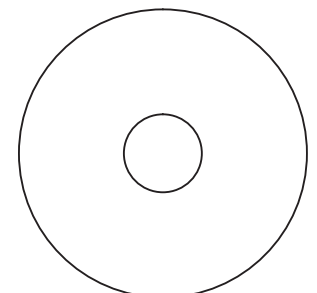
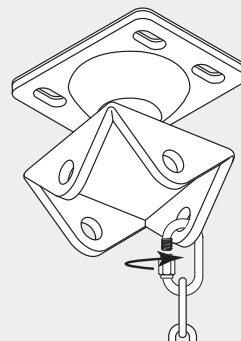

3/8 x 1-1/2" Flat Washer

CAUTION: It is extremely important that you perform a monthly inspection of all swing type activities. The components **MUST** be checked for wear and to make sure all of the hardware is tight. The Tire Swivel is also equipped with a grease fitting and should be lubricated periodically.